



Sunday
ON THE HOUSE

What if everyday could
end in a holiday.





Sunday is not a weekly off.
Or a day when you get up late.
Sunday is a way of life where
there is no room for stress
and a feeling of happiness
best experienced with the ones
you truly love; be it family,
friends or neighbours.
Sunday is a state-of-mind and
can be your permanent address
for generations to come.



Your address
can reflect your
state-of-mind.

Close to all things important.
Close to your heart.

Sunday awaits you amidst the greenery just off the 6 lane major arterial road at Hatia in New Town, Rajarhat. Located in one of the poshest areas in Kolkata's newly planned eastern suburb, Sunday is close to City Centre II, IT Parks as well as the Eco Park.



- A) 100 meters from City Centre II and Swissotel Kolkata B) 1.5 kms from VIP Road
- C) 4 kms from the domestic and international airport D) 5 kms from the Central Business District
- E) 1.5 kms from the multi-specialty Charnock Hospital F) About 7 kms away from major schools such as DPS Rajarhat and DPS Megacity G) 5 kms from Eco Tourism Park
- H) About 10 kms from Sector V, Salt Lake City



- Yet it is close to everything you need. Sunday is a cosy, personalised group of over 100 residences spread over 108 cottahs. With a cluster of G+5 storey blocks, Sunday offers spacious, airy and thoughtfully planned residences in sizes ranging from 2 BHK to 3.5 BHK.
- A) 100 meters from City Centre II and Swissotel Kolkata B) 1.5 kms from VIP Road
 C) 4 kms from the domestic and international airport D) 5 kms from the Central Business District
 E) 1.5 kms from the multi-specialty Charnock Hospital F) About 7 kms away from major schools such as DPS Rajarhat and DPS Megacity G) 5 kms from Eco Tourism Park
 H) About 10 kms from Sector V, Salt Lake City

Quality construction for quality living.

STRUCTURE

- Reinforced concrete frame structure with premium quality cement

WALLS

- Conventional fly ash brick/AEC block brick work for internal and external walls plastered with cement
- Plaster of Paris inside and in the common area

FLOORING

- Vitrified Tiles in Bedrooms, Living/ Dining area • Anti-skid vitrified floor tiles in the Kitchen & Bathrooms
- Glazed Tiles on the Bathroom walls up to height of the door
- Common staircase and lobby in Kota/equivalent stone finish

KITCHEN

- Granite platform with honed edges
- Dado tiles up to 2 ft above the counter and platform
- Stainless steel sink with provision for hot & cold water line

WINDOWS

- Fully glazed sliding anodized aluminum window with 4 mm clear glass

ELECTRICAL

- Concealed copper wiring (ISI mark)
- Modular switches and ample electrical points of 15/5 amp
- AC points in all Bedrooms, Living/Dining area

LIFT

- Otis/Kone/or equivalent make

DOORS

- 32 mm Flush Doors with 2 coats of primer and paint
- Main Door with Godrej night latch and eyepiece

SANITARY FITTINGS

- Quality white sanitary ware fittings
- Hot & cold water lines in shower and basin
- Geyser and exhaust fan provision
- CP fittings of good quality Jaquar/equivalent make (ISI mark)





Just like your home
every moment should
last you a lifetime.

Good times
become great
when shared.





ZRICKS.COM

More space for your children to play and the elderly to catch up. Ample space to park your child's tricycles or your car. Less sound of traffic and electric horns. It's not about the square feet, each home at Sunday is designed to provide more mindspace per family.

- Ample parking space
- Swimming pool
- Club with children's play area and facilities like library, carrom, pool table and table tennis
- Badminton court
- AC gym
- Meditation centre for yoga
- AC community hall
- Separate children's park
- Adda and walking track for senior residents
- Advanced fire safety and emergency services



Architects: Agrawal & Agrawal



TYPE OF FLAT	A	B	C	D	E	F	G	H	I	J	K	L	M
NO OF FLAT	05	05	05	05	05	05	05	05	05	05	05	05	05
CLOUR													



LEGEND OF FACILITIES

01 Badminton Court

02 Club House

03 Children's Park

04 Swimming Pool





ZRICKS

BLOCK 1: TYPICAL FLOOR
2 and 3 BHK

NO OF FLAT	TYPE	SALEABLE AREA
05	A	1650 SQ.FT
05	B	1255 SQ.FT
05	C	1181 SQ.FT
05	D	1518 SQ.FT



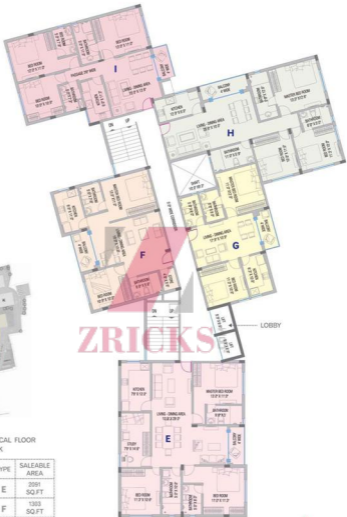

BLOCK 2: TYPICAL FLOOR
2, 2.5 and 3 BHK

NO OF FLAT	TYPE	SALEABLE AREA
05	E	2091 SQ.FT
05	F	1303 SQ.FT
05	G	1097 SQ.FT
05	H	1753 SQ.FT
05	I	1576 SQ.FT





BLOCK 3: TYPICAL FLOOR
2, 3 and 3.5 BHK

NO OF FLAT	TYPE	SALEABLE AREA
05	J	1303 SQ.FT
05	K	2032 SQ.FT
05	L	1885 SQ.FT
05	M	1750 SQ.FT



Sometimes how happy you are at work is decided by the comforts you have at home.



On The House:
The quality is on us



Buying a home is probably the most important decision you will ever make. We understand that, and work closely with the finest architects, structural engineers, landscape artists and other professionals so that you can relax. While we anticipate your needs, check for the finest materials and attempt to make the process of purchasing a home a truly enjoyable one. Do visit our website onthehouse.co.in to see our earlier projects and understand why we are not your regular builder.

A couple is relaxing on a light-colored sofa in front of a large window. The window looks out onto a cityscape. A decorative graphic overlay is centered on the window, featuring a stylized 'Z' logo in pink and grey, a bird's nest with two birds, and various floral and vine motifs in white and pink. The text 'ZRICKS.COM' is written in pink below the logo.

ZRICKS.COM

Sunday On The House

Hatiara, New Town, Rajarhat

Kolkata 700157

www.onthehouse.co.in/sunday

Architects: Agrawal & Agrawal

Solicitors: AK Chowdhary & Co



www.onthehouse.co.in

Please Note: All rates, amounts, amenities, features, specifications, other information, etc. mentioned are indicative of the best of development that is proposed and are subject to the approval of the respective authorities. There may be slight variations.